

Small rechargeable batteries, including lithium-ion batteries, that are no longer needed will be collected once a week on Resource Day.

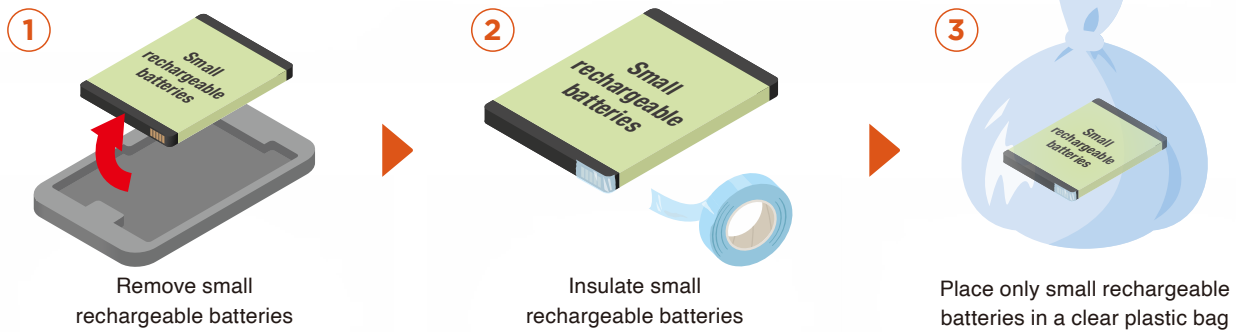

Before disposal, cover the terminals and cable ports with tape to **insulate** them, and place **only the small rechargeable batteries** in a clear plastic bag.

* Insulation prevents electrical conductivity.



Until Fiscal Year 2024

Small rechargeable batteries were collected at JBRC-affiliated collection stores (electronics retailers, etc.). Deformed or swollen batteries that were not accepted could be taken to a waste collection office or waste collection center.



From Fiscal Year 2025

Small rechargeable batteries will be collected once a week at designated Resource Collection Sites on Resource Day.

You can still take them to JBRC-affiliated collection stores.

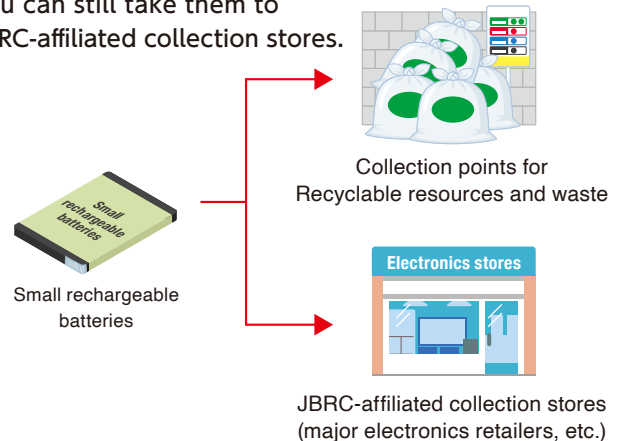

* Deformed or swollen small rechargeable batteries are extremely dangerous. Please bring them to a waste collection office or waste collection center.

Items Collectible on Resource Day



- **Individual** small rechargeable batteries
⇒ Look for this mark on the right



Nickel-cadmium batteries



Nickel-metal hydride batteries



Lithium-ion batteries

- For small electronic devices with built-in small rechargeable batteries, remove the battery before disposal. Dispose of the device itself as metal, ceramic, or glass waste. However, do not disassemble power banks, but dispose of them as Recyclable resources on Resource Day.

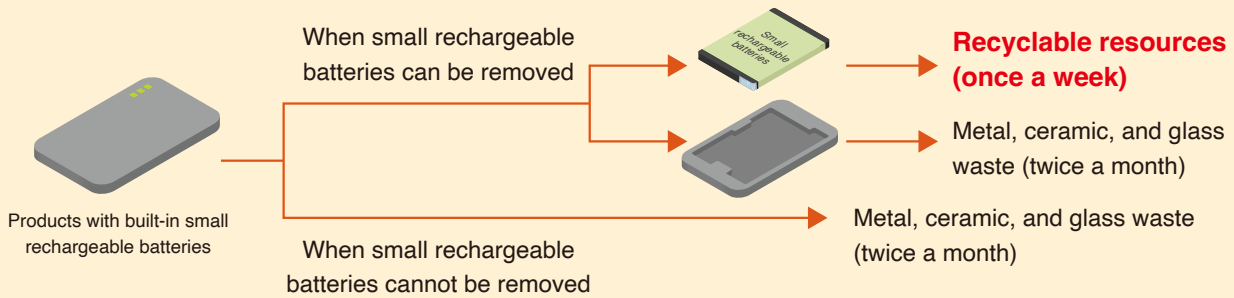

Items Not Collectible on Resource Day



- Small electronics items with built-in small rechargeable batteries
⇒ Dispose of them as metal, ceramic, and glass waste.
- Computers (Note: removed small rechargeable batteries will be collected)
⇒ Dispose of them through certified electronics recyclers in accordance with the Small Home Appliance Recycling Law.
- Car and motorcycle batteries
⇒ Not accepted by Shinjuku City. Contact a specialized disposal service.

What are small rechargeable batteries?

They are batteries that can be recharged and used repeatedly (secondary batteries). As shown in the examples of products with built-in small rechargeable batteries, they are commonly used in electronic devices that can operate without being plugged in.

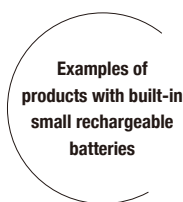
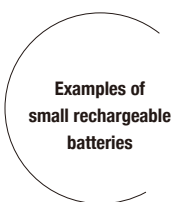

⇒ **If small rechargeable batteries cannot be removed, please dispose of such items as metal, ceramic, and glass waste!**



Improper disposal may cause fires

Lithium-ion batteries may overheat or ignite if damaged or handled improperly!
When disposing of them on Resource Day, do not mix them with other Recyclable resources, such as plastic.

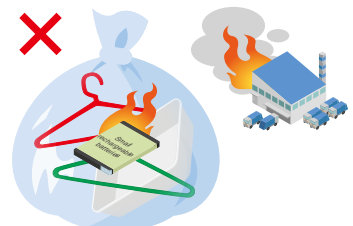

Contact Information

Shinjuku Waste Collection Office
03-3950-2923

Shinjuku Higashi Waste Collection Center
03-3353-9471

Kabukicho Waste Collection Center
03-3200-5339